

[fpmccann.co.uk/architectural](http://fpmccann.co.uk/architectural)

THINKING PRECAST?  
THINK FP MCCANN



# ARCHITECTURAL PRECAST SOLUTIONS



# ARCHITECTURAL PRECAST



Precast concrete is the perfect material to link the practical with the desirable. The technical benefits and aesthetic possibilities appeal to both clients and designers alike.

FP McCann offers all forms of architectural precast components, either as structural load-bearing members built as part of the primary frame, such as an external sandwich panel or structural columns; or as a decorative cladding element to the facades, like spandrels, mullions or full storey high panels. Precast concrete is ideal as a cladding material, especially where complex geometry on the facades have to be achieved, access is restricted, or the project programme demands fast on-site construction. Our in-house design and technical department provides reassurance that the structural and aesthetical requirements of your scheme are met. In order to achieve the best solution and to ensure the most cost-effective approach, we recommend contacting us at an early stage of your project so that we can provide the maximum technical input.

**Acid etched, Grit Blasted, Polished, Exposed Aggregate, Brick-Faced, Stone-Faced and Tile-Faced precast cladding can all be provided.**

## KEY ADVANTAGES

- Precast concrete can be provided in a variety of colours and finishes, utilising a large choice of aggregates and pigments
- Architectural concrete can be both structural load-bearing or non-structural such as cladding. All of our architectural projects are designed and manufactured in a completely bespoke manner
- Concrete is durable, strong and resistant to impact. It also has excellent fire-resistant and acoustic properties
- Designed and manufactured off-site ensures consistent quality and lower construction costs
- Units can be manufactured to suit different building structures
- Brick, stone or tile faced units can be supplied fully pointed

## INSTALLATION AS EASY AS....

# 1

Units delivered on our specialist trailers on a just-in-time basis to suit your construction project

# 2

Craned into position and fully installed, all undertaken by fully trained specialist precast installers

# 3

Complete all finishing works, as required, such as jointing, insulation, fire-stop, etc

# STANDARD SOLUTIONS



Fully pointed with windows built-in

The illustration above shows a large brick-faced panel, pre-glazed at our works.

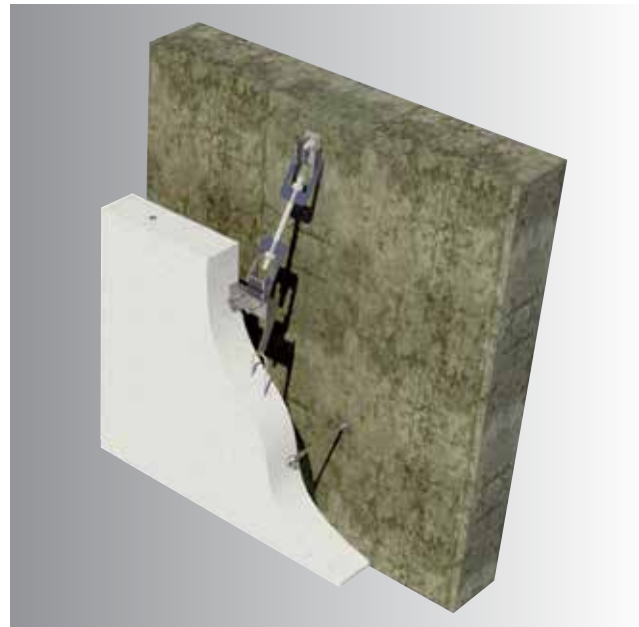

Facade panels

The illustration above shows a facade panel which can be tied back to either a concrete frame or steel.



Textured/pattern imprinted cladding panels

# LINTELS & SOFFITS

Recessed openings and deep reveals have become increasingly popular design features, creating depth within an elevation and giving additional visual flare to a facade. These areas have been perceived as difficult to treat - until now.

Precast concrete panels with bricks cast-in are often used as a cladding material, especially in areas that can be perceived as difficult or complex to treat. Features may range from the more traditional flat gauged arch to a contemporary stretcher bond lintel, or deep brickwork returned soffits which give extra depth to an opening.

FP McCann's brick support solutions provide structural reassurance that meet the required aesthetics, yet gives the impression of unsupported brickwork, whether it's a bearing lintel or a supported soffit.

Precast concrete brick-faced lintels provide an excellent robust masonry support solution around door and window openings, whilst maintaining the effect of brick bonding throughout a facade.

## KEY ADVANTAGES

- Brick-faced lintels are structural bearing units that add stability to the masonry around an opening
- Using a brickwork support angle, brick-faced soffits/underslung units can be supplied in small component lengths, giving the appearance of a continuous span over an opening
- Components can be pointed on-site to ensure mortar colour consistency with the surrounding brickwork
- Designed and manufactured off-site ensures consistent quality and lower construction costs
- Units can be manufactured to suit difference brick dims and bond patterns
- Brick-faced lintels do not interrupt brickwork aesthetics

**Most brick and masonry types, bond patterns and styles can be catered for.**

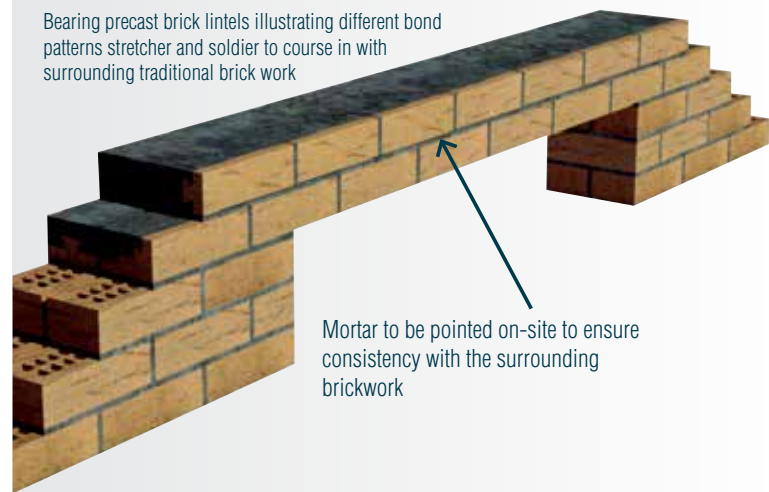

Bearing Lintels

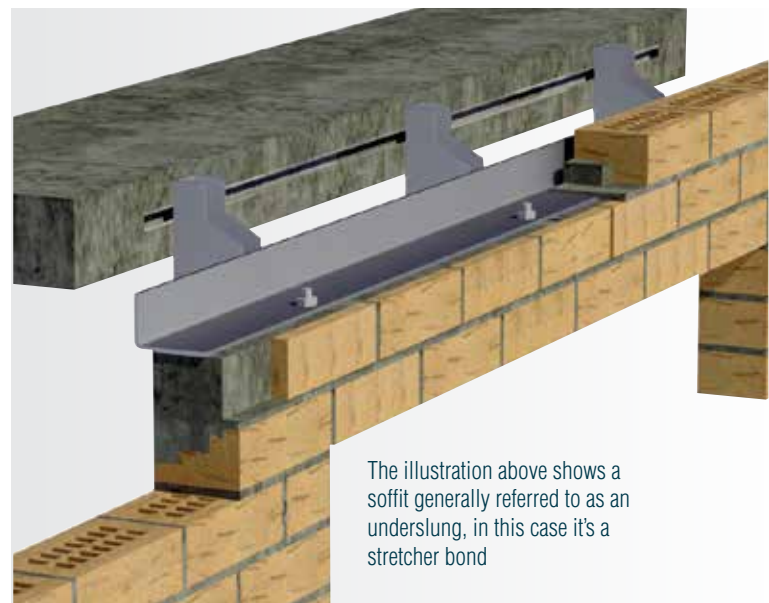

Underslung brick-faced soffits

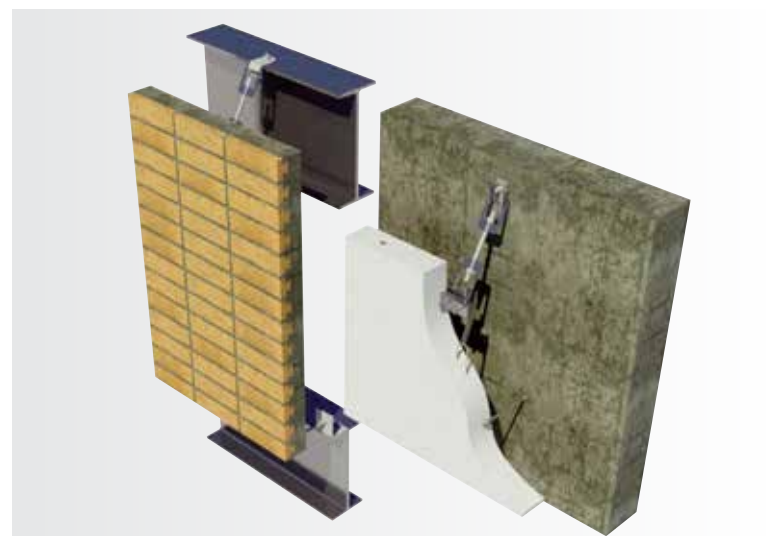

Facade panels

The illustration above shows brick and concrete facade panels which can be tied back to either a concrete frame or steel.

# COLUMNS & BALCONIES

FP McCann offers a range of precast concrete columns and balconies to suit all specifications. All of our products are designed and manufactured to meet client requirements, including additional features and fittings, if required.

## BALCONIES

Balconies not only provide extra outside space but also create a visual feature to a facade.

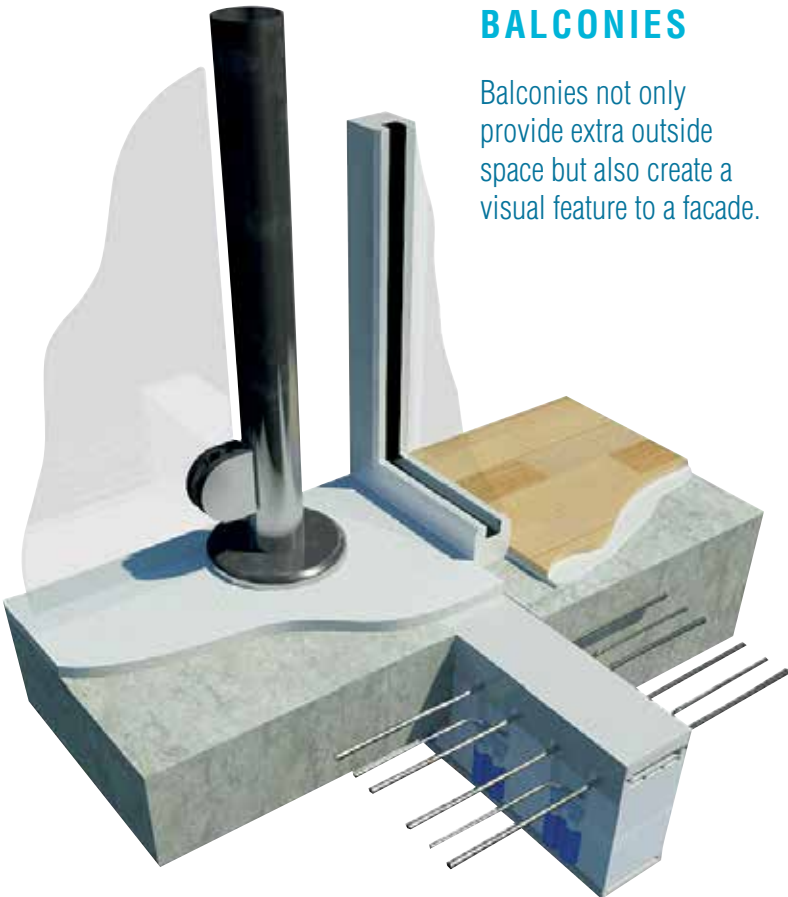

## BENEFITS OF PRECAST BALCONIES

- Balconies can be erected with floor units prior to pouring of screed
- Balconies can be manufactured to suit any architectural and/or structural design
- Time saved on-site
- Designed and manufactured off-site ensures consistent quality and lower construction costs
- Cold bridging can be overcome by incorporating an insulated balcony connector (thermal break) as part of the balcony connecting kit

## KEY BENEFITS OF USING PRECAST CONCRETE STRUCTURES

- Increases speed of construction between levels
- Helps reduce margins of error
- High compressive strength
- Eliminates complex pours on-site
- Reduces Health and Safety risks on-site. Health and Safety statistics indicate that fatal accidents are five times more likely on-site than in a factory controlled environment
- Detailed and manufactured to your specification, incorporating additional features and fittings, if required

## BENEFITS OF PRECAST COLUMNS

- Precast columns can be circular, square, rectangular or oval. A range of standard columns are available
- Precast concrete columns may be single or double storey height
- Connections may be made via a base plate to the column or by reinforcing bars projecting from the cast, or set into a preformed hole in a foundation block and grouted into position





# INTRODUCING FP MCCANN'S Architectural & Structural Precast Team



## **JAMES DONINGTON**

Architectural Precast  
jdonington@fpmccann.co.uk  
07711 389421

*Area covered:*

*Midlands, South Wales &  
South England*



## **DANIEL WESTGATE**

Structural Precast  
dwestgate@fpmccann.co.uk  
07809 538726

*Areas covered:*

*Scotland, North England &  
Midlands*



## **GREG SAUNDERS**

Architectural Precast  
gsaunders@fpmccann.co.uk  
07809 538558

*Areas covered:*

*Scotland, North England &  
Midlands*



## **GAVIN LOWE**

Structural Precast  
glowe@fpmccann.co.uk  
07976 206521

*Areas covered:*

*South West, South East  
Wales & London*

## **LONDON OFFICE:**

Hamilton House,  
Mabledon Place,  
London, WC1H 9BB  
**T. 020 3905 7640**  
sales@fpmccann.co.uk

## **BYLEY OFFICE:**

Byley Road,  
Byley, Middlewich  
Cheshire, CW10 9RJ  
**T. 01606 843500**  
sales@fpmccann.co.uk

[fpmccann.co.uk/architectural](http://fpmccann.co.uk/architectural)

